

DETAILS

Product Number	CA11264_HEIDI-D
Family	Heidi
Type	Assembly
Color	clear
Diameter	21,6 mm
Height	11,7 mm
Style	round
Optic Material	PMMA
Holder Material	
Fastening	pin, tape
Status	production ready
ROHS Compliant	Yes
Date Updated	8/06/2016



OPTICAL PROPERTIES

LED	Viewing Angle	Light Beam	Efficiency	cd/lm	Connector
XP-G	12 deg	Diffuser	93 %	14.500	-
XP-E	9 deg	Diffuser	93 %	22.000	-
XB-D	10 deg	Diffuser	90 %	12.550	-
XT-E	10 deg	Diffuser	90 %	14.300	-
XP-G2	11 deg	Diffuser	88 %	15.000	-
XP-E2	10 deg	Diffuser	88 %	17.400	-
XB-H	11 deg	Diffuser	87 %	12.700	-
XQ-E HI	7 deg	Diffuser	93 %	24.800	-
LUXEON T	12 deg	Diffuser	89 %	11.500	-
LUXEON TX	12 deg	Diffuser	88 %	13.600	-
LUXEON Z ES	sim: 7,7	Diffuser	sim: 94 %	sim: 33.500-	
LUXEON C	9 deg	Diffuser	89 %	17.800	-
NCSxx19A	9 deg	Diffuser	88 %	11.900	-
NVSxx19A	12 deg	Diffuser	88 %	8.900	-
NVSxx19B/NVSxx19C	14 deg	Diffuser	91 %	10.000	-
NCSxx19B	11 deg	Diffuser	85 %	14.200	-
Oslon SSL 80	7 deg	Diffuser	89 %	19.300	-
Oslon SSL 150	9 deg	Diffuser	92 %	15.000	-
Oslon Square EC	10 deg	Diffuser	90 %	12.900	-
Oslon Square Gen3	sim: 13	Diffuser	sim: 94 %	sim: 13.300-	
LH351Z	12 deg	Diffuser	88 %	13.300	-
LH351B	14 deg	Diffuser	88 %	10.000	-
Z5	8 deg	Diffuser	87 %	22.300	-
Z5M1/Z5M2	sim: 10	Diffuser	sim: 90 %	sim: 17.000-	

Relative intensity of CA11264_HEIDI-D-(XPG2)

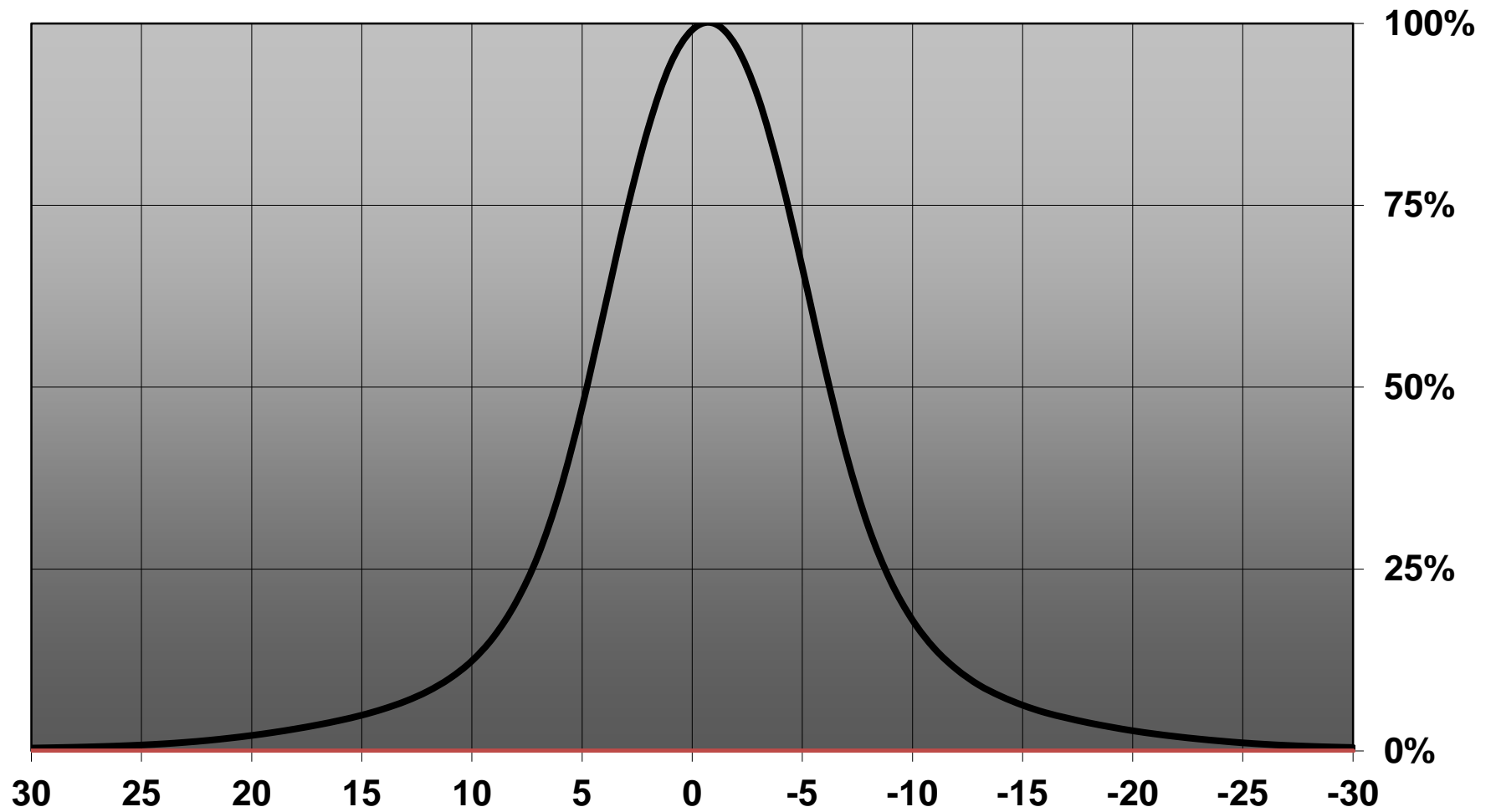

Relative intensity of CA11264_HEIDI-D_(XB-H)

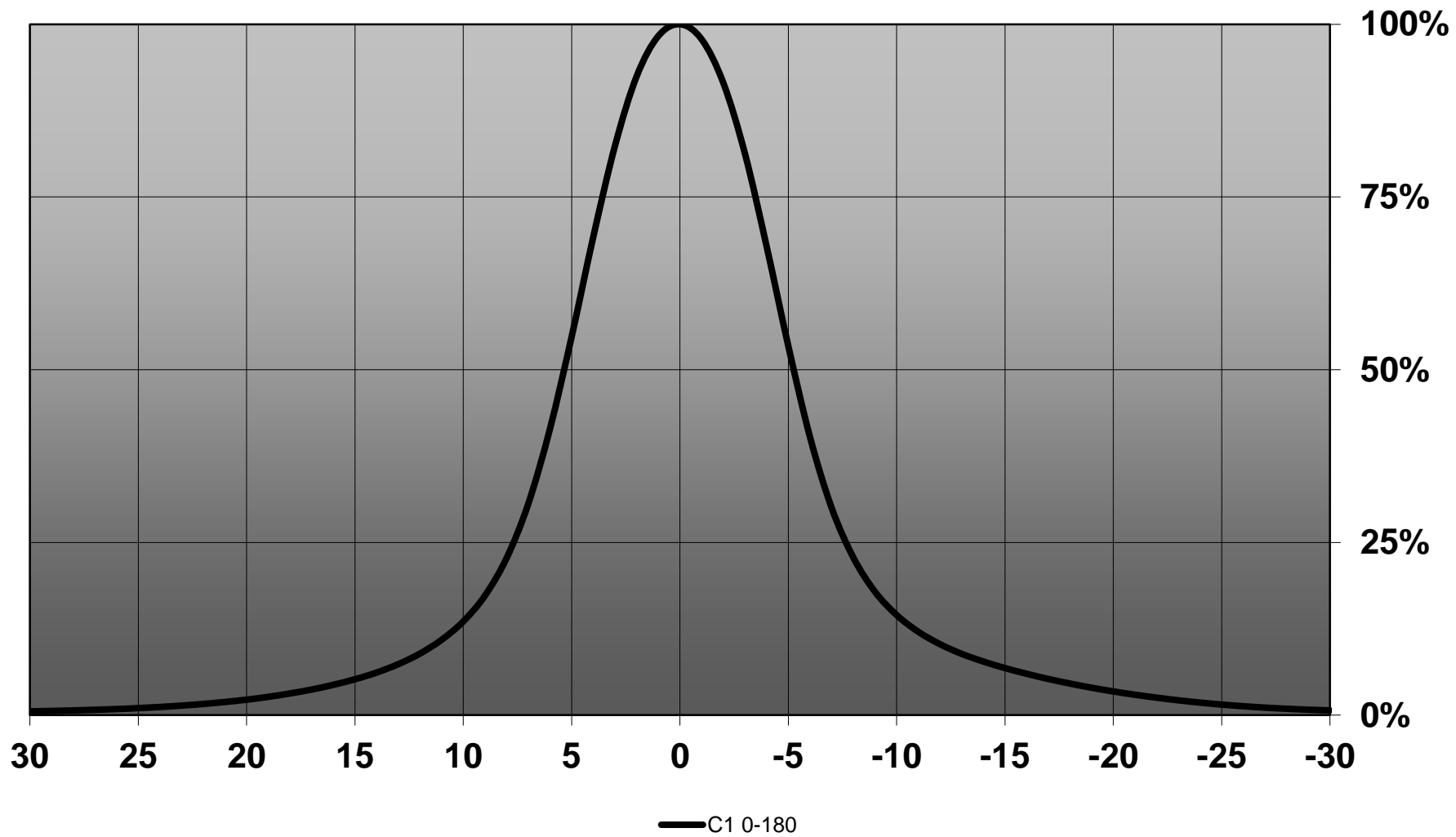

D

C

B

A

4

4

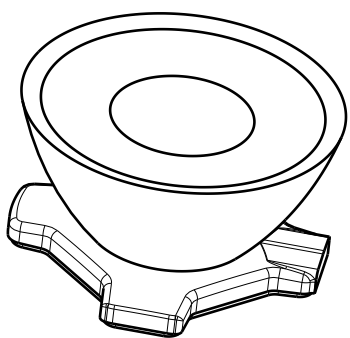

Isometric view

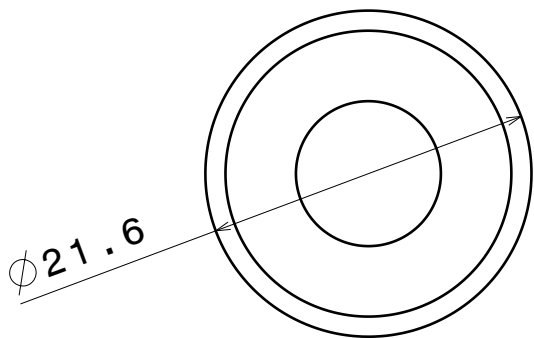

Top view

3

3

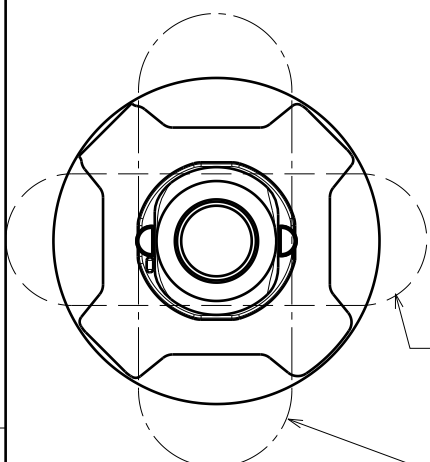

Bottom view
OVAL BEAM direction

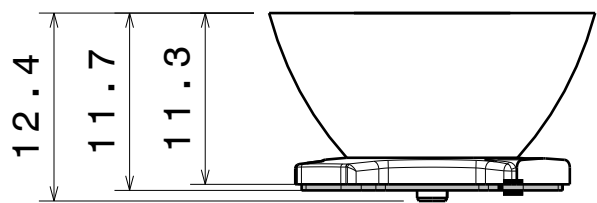

Front view

2

2

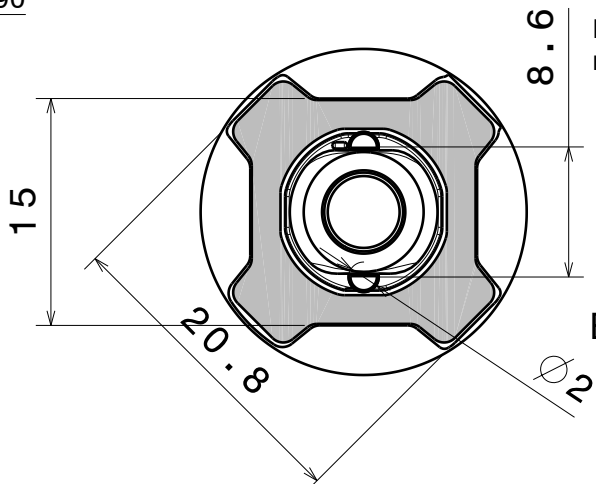

Bottom view

Material:
Lens PMMA
Tape PU Foam

This drawing is our property.
It can't be reproduced
or communicated without
our written agreement.



Ledil Oy
Salorankatu 10
FIN-24100 SALO
Finland

DRAWING TITLE
Datasheet Heidi-Series Assy

DRAWN BY
ah

DATE
1.2.2012

CHECKED BY

DATE

SIZE
A4

DRAWING NUMBER

REV
2

DESIGNED BY

DATE

SCALE 2:1

WEIGHT (g)

SHEET

1/1

D

A

1

1

Luminaire: LEDiL Oy CA11264_HEIDI-D_(XP-G2) Efficiency=88%
Lamps: 1 x Cree XP-G2 103lm @ 250mA CCT= P=0.80W I=250mA

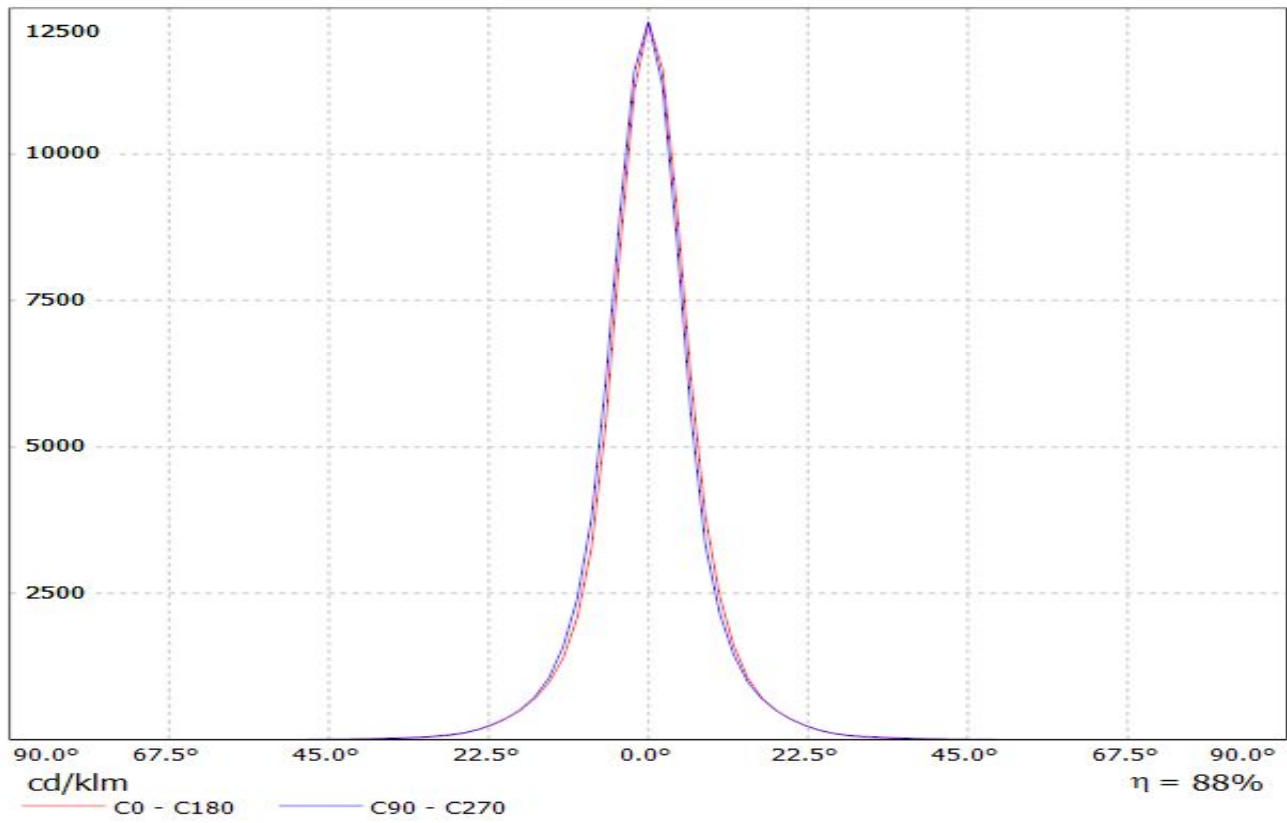

Luminaire: LEDiL Oy CA11264_HEIDI-D Eff. 88%
Lamps: 1 x Cree XP-E2 92lm@250mA CCT=5500K P=0.8W

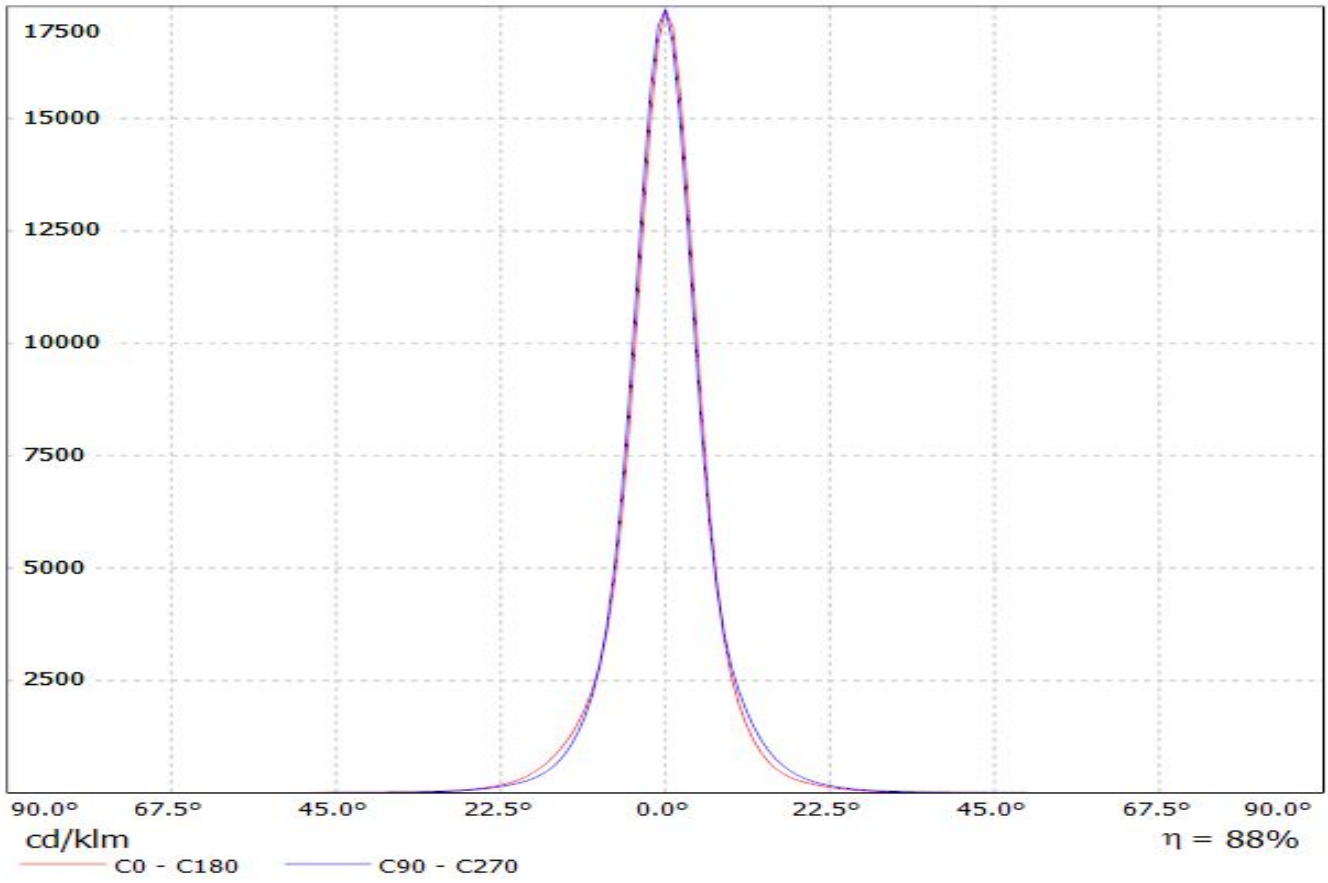

Luminaire: LEDiL Oy CA11264_HEIDI-D_(XQ-E-HI)

Lamps: 1 x Cree_XQ-E_HI_100.602lm@250mA_P=0.744629W_I=0.25A

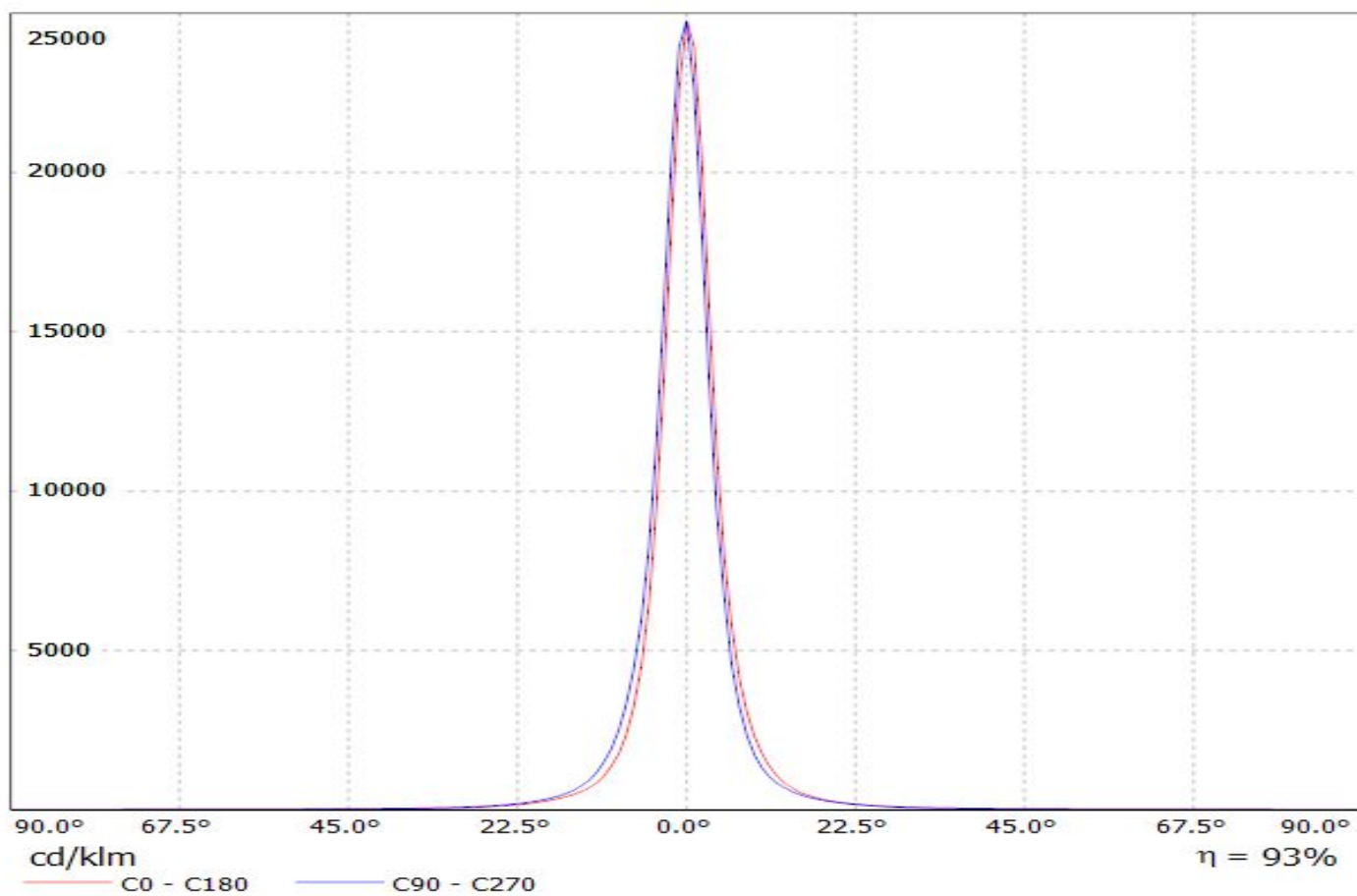

LEDiL Oy CA11264_HEIDI-D_(LUXEON_T)_2 Eff.90.1% / LDC (Linear)

Luminaire: LEDiL Oy CA11264_HEIDI-D_(LUXEON_T)_2 Eff.90.1%
Lamps: 1 x LUXEON T (74lm@250mA)

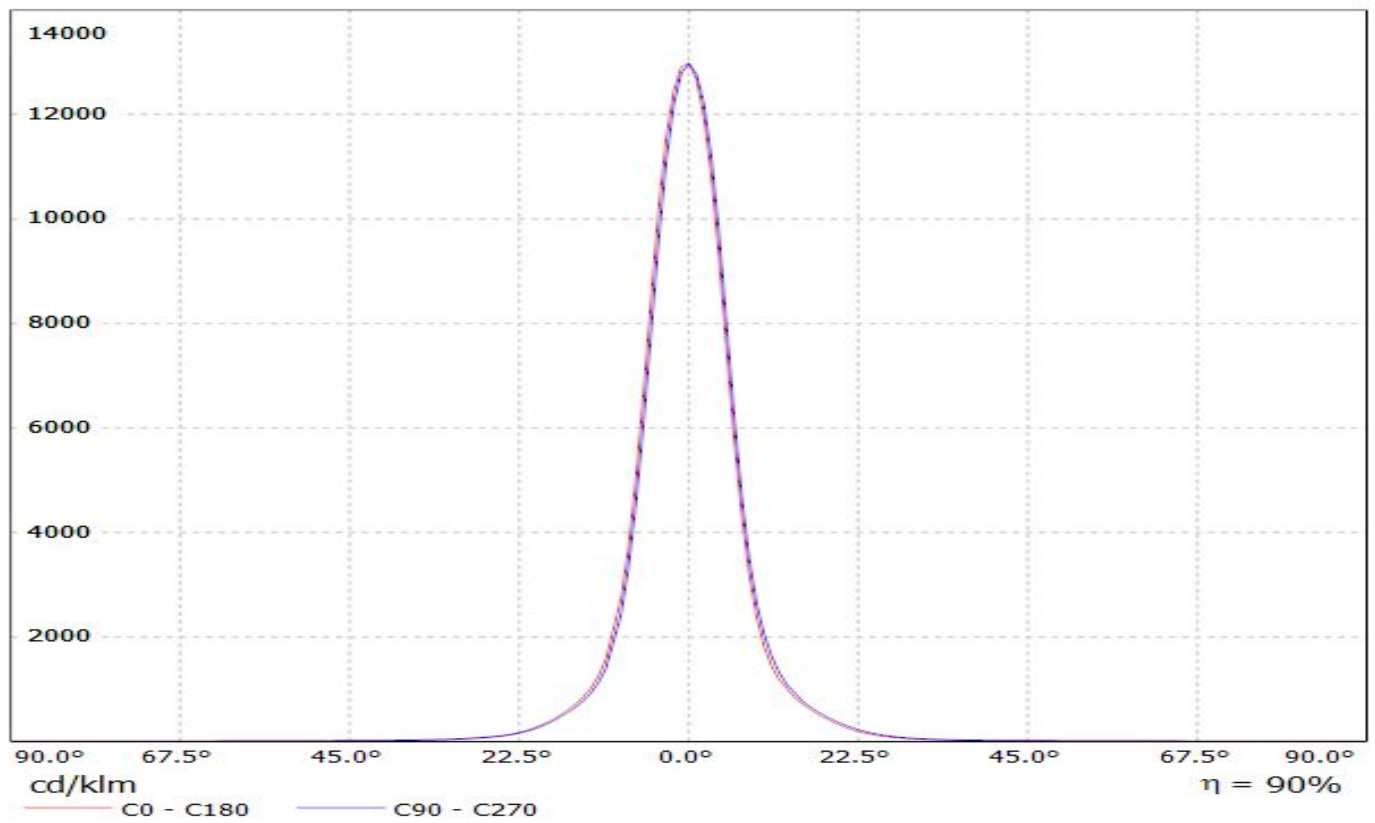

Luminaire: Ledil Oy CA11264_HEIDI-D_(Luxeon_TX) Efficiency= 88%
Lamps: 1 x Luxeon TX (L1T2-3585) 82lm @ 250mA CCT=3521K P=0.73W I=250mA

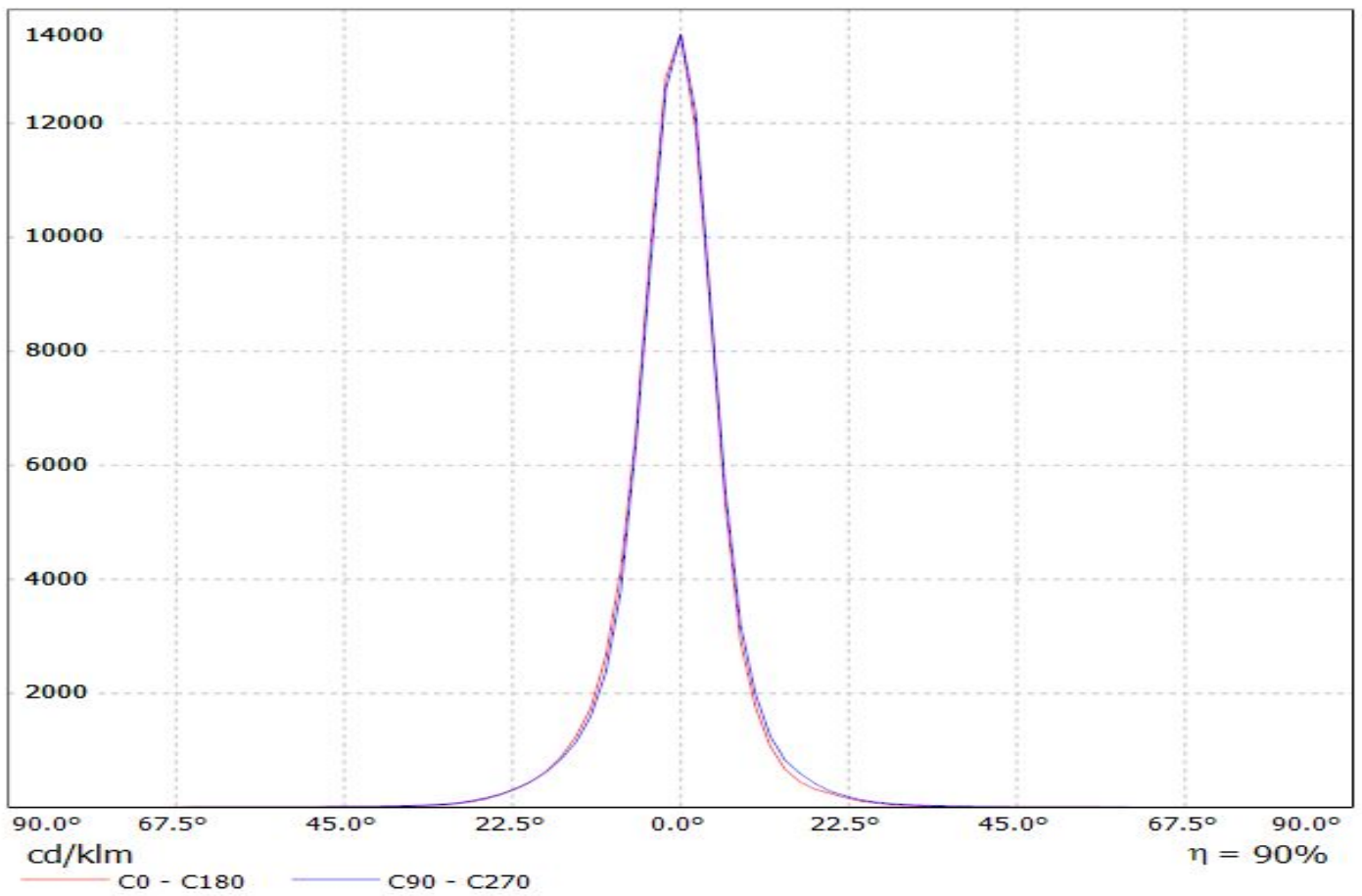

Luminaire: Ledil Oy CA11264_HEIDI-D_(Luxeon_Z_ES)_SIMULATED
Lamps: 1 x Lumileds Luxeon Z ES

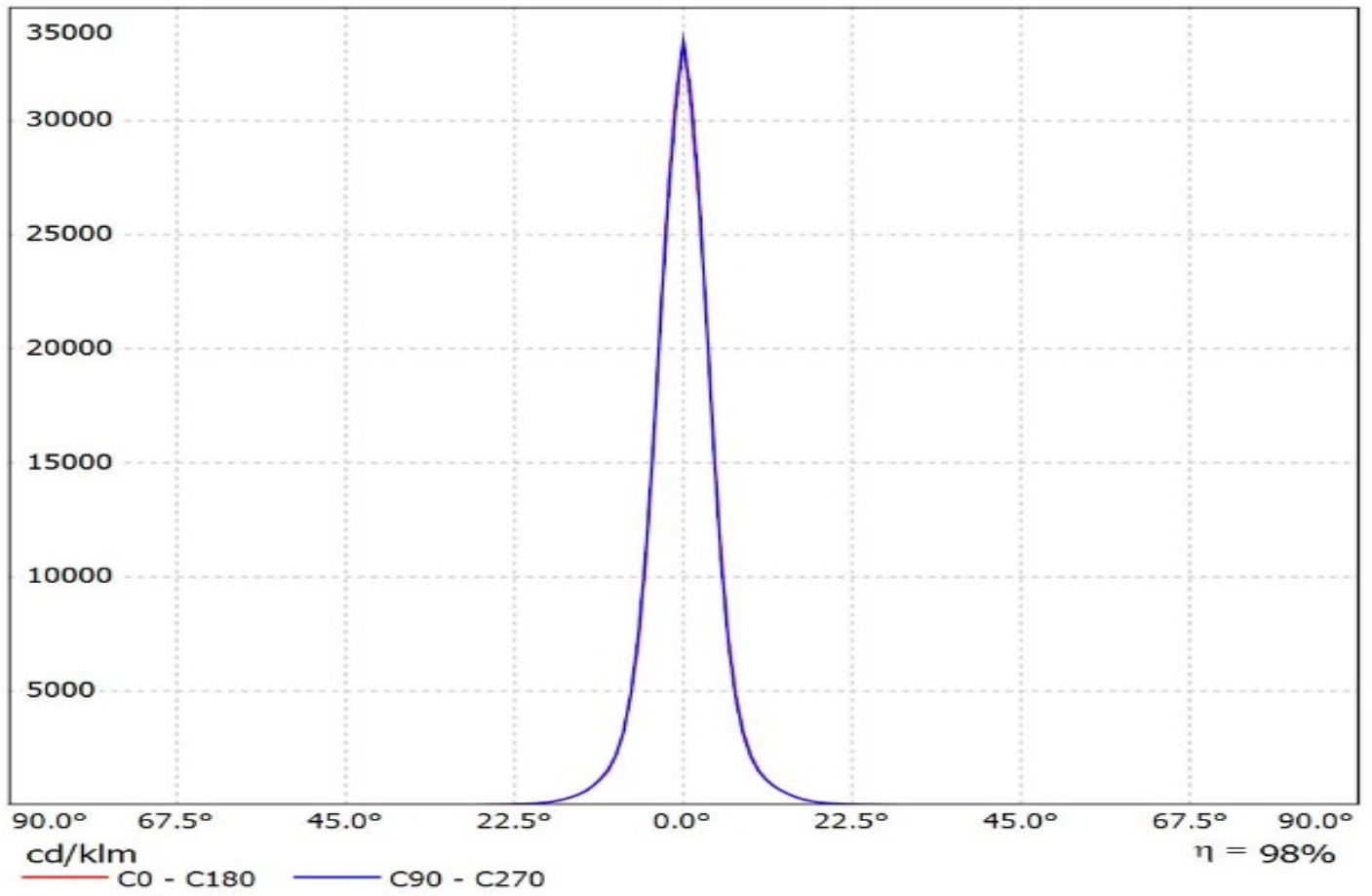

Luminaire: LEDiL Oy CA11264_HEIDI-D_(Luxeon_C_WHITE)
Lamps: 1 x Luxeon_C_WHITE_84.6969lm@250mA_P=0.7410W_I=0.250A

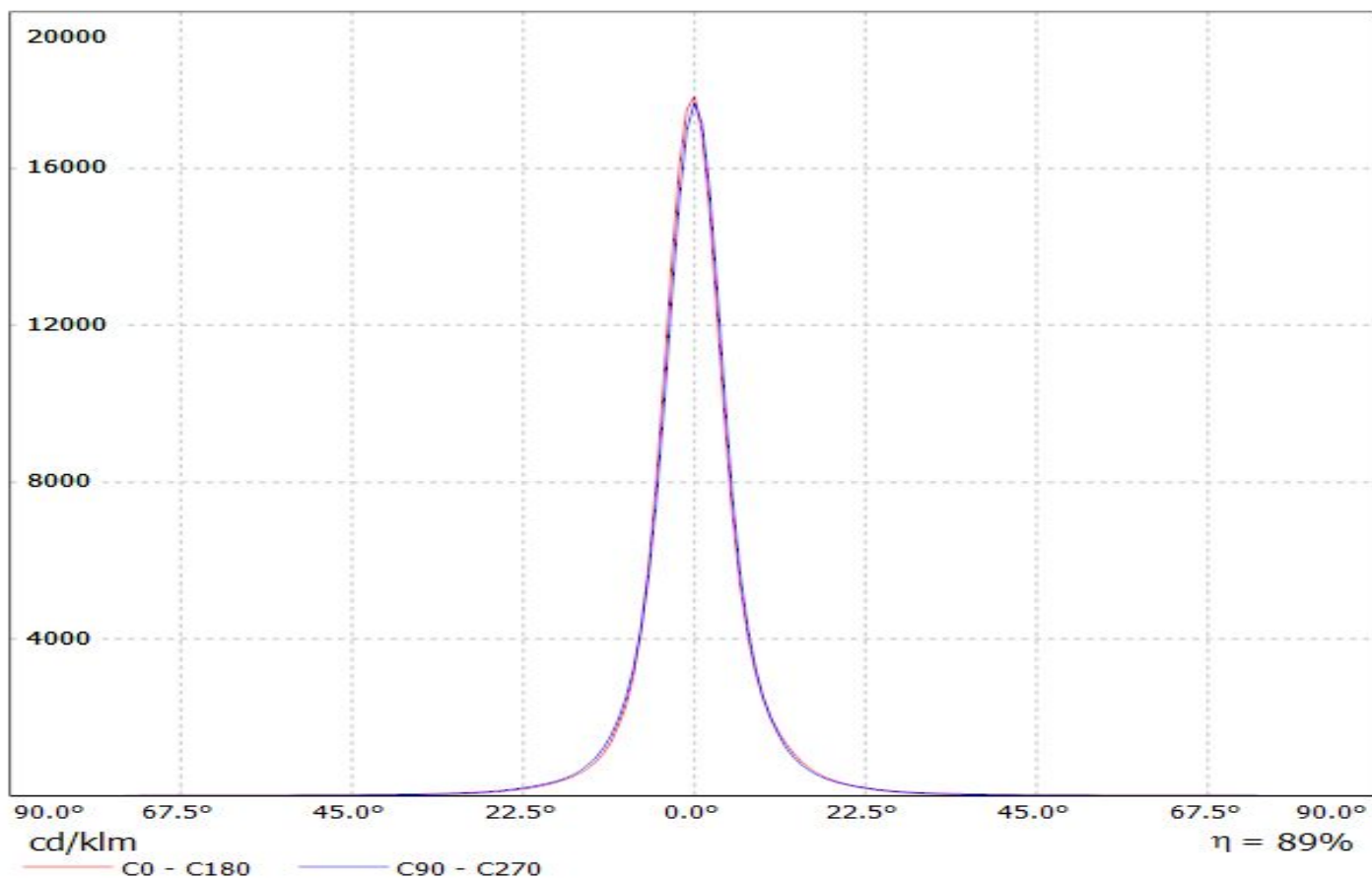

Luminaire: Ledil Oy CA11264_HEIDI-D (Nichia 219B 109lm @ 250mA) Efficiency=91%
Lamps: 1 x Nichia 219B 109lm @ 250mA

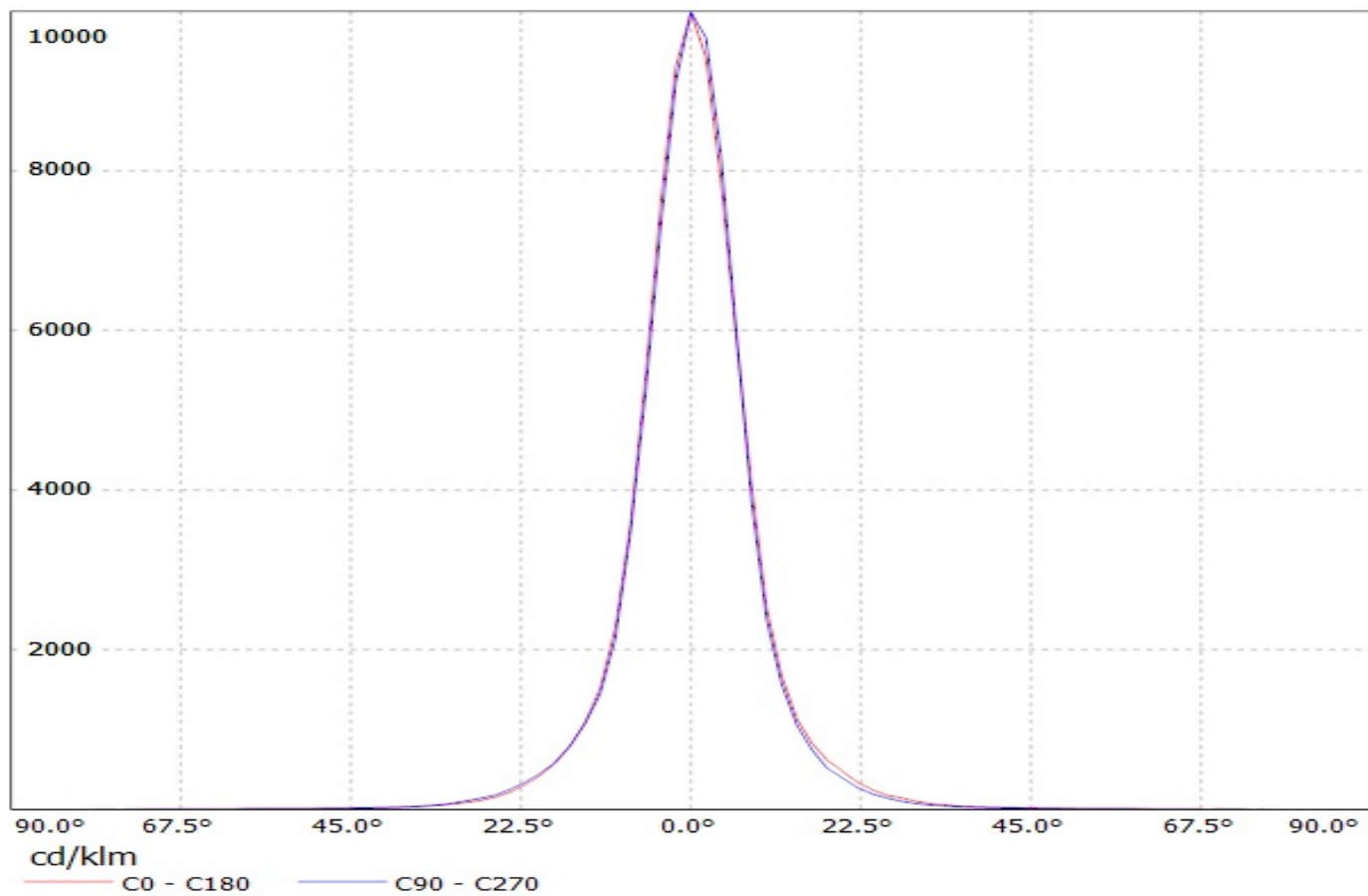

Luminaire: Ledil Oy CA11264_HEIDI-D_(NCSxx19B) Efficiency=85%
Lamps: 1 x Nichia NCSxx19B (NCSL119BE) 88lm @ 250mA CCT=3000K P=0.8W I=250mA

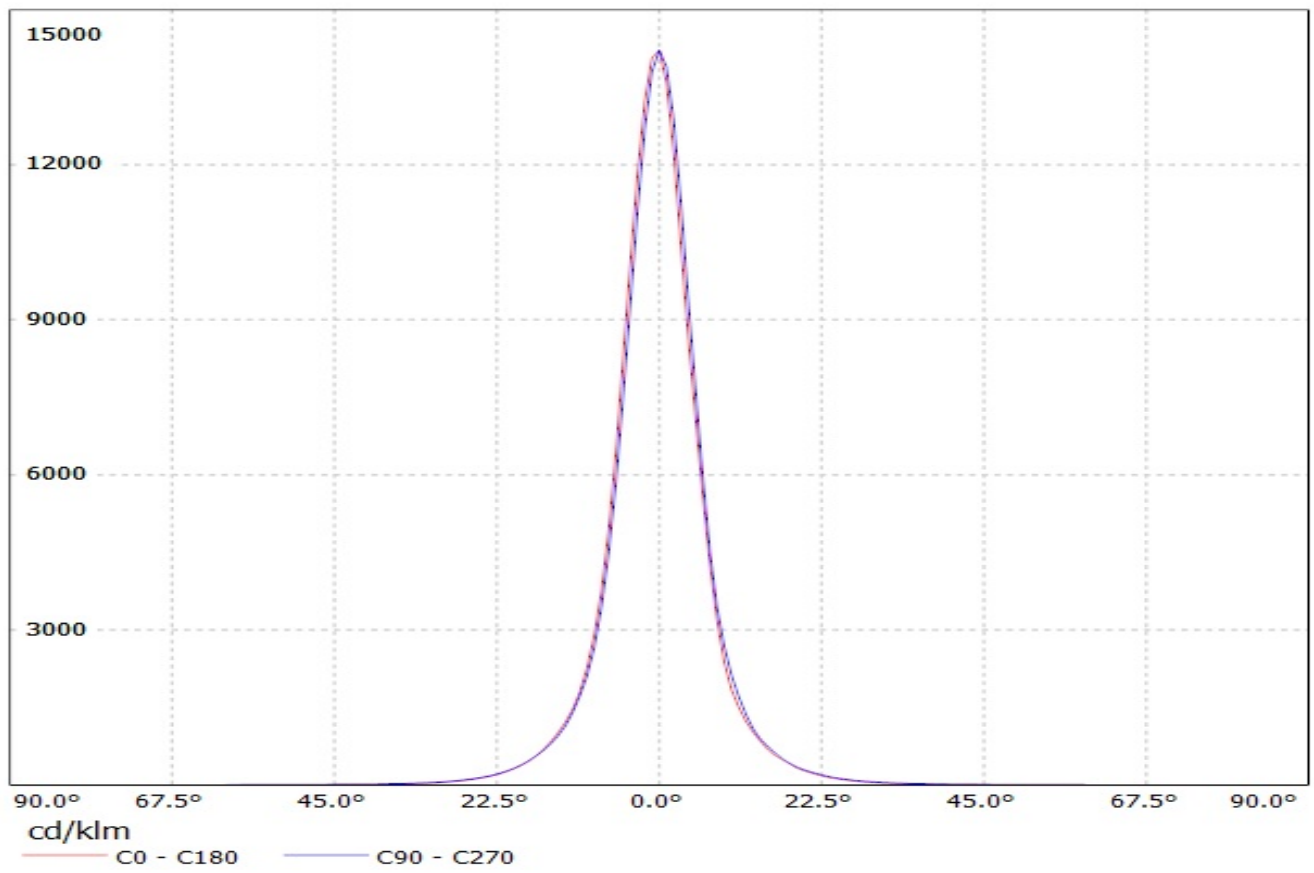

Luminaire: Ledil Oy CA11264_HEIDI-D_(LH351Z) Efficiency=88%
Lamps: 1 x Samsung LH351Z (90.14lm @ 250mA) CCT=6500K P=0.7W I=250mA

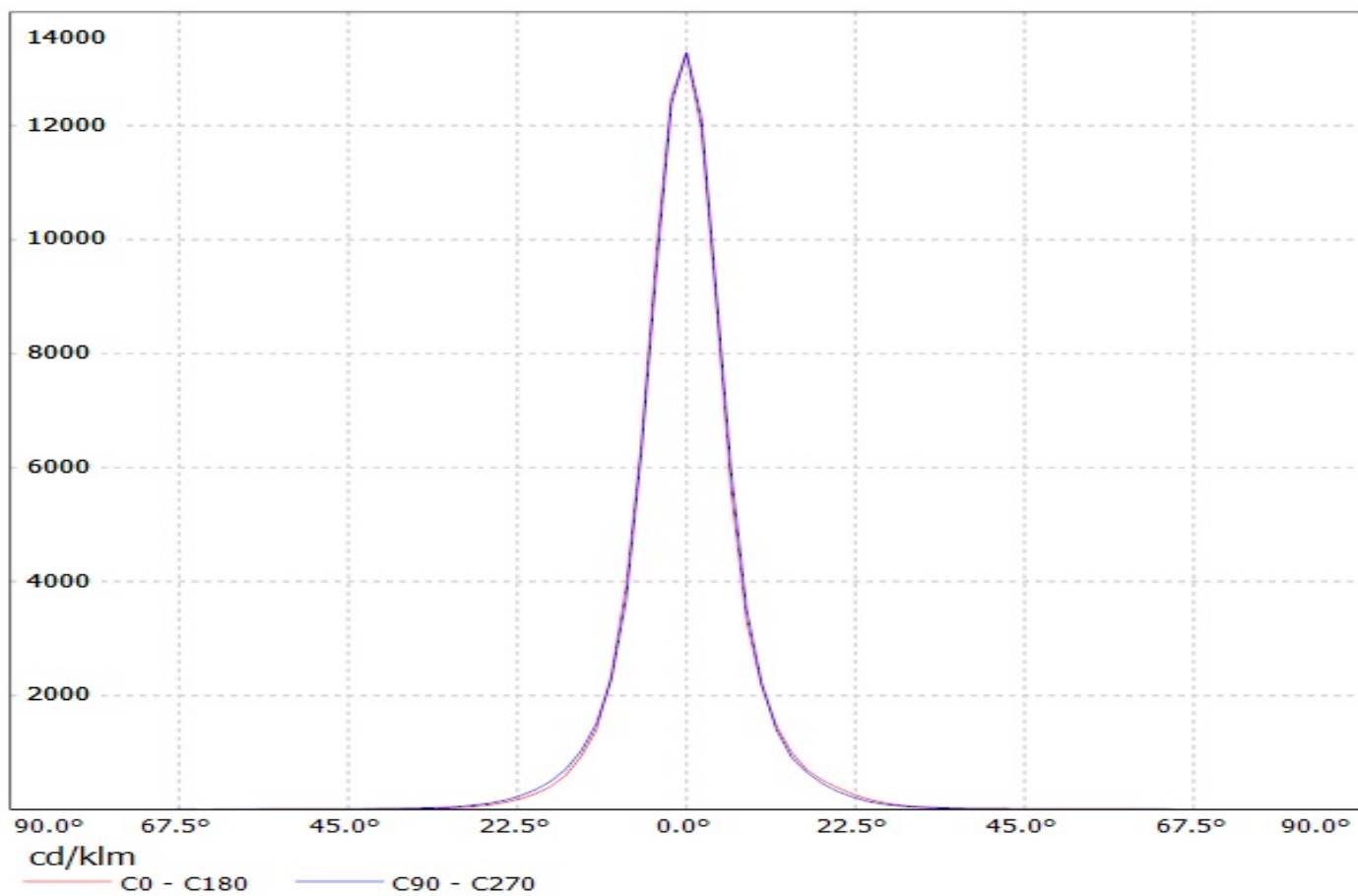

Luminaire: Ledil Oy CA11264_HEIDI-D_(LH351B)
Lamps: 1 x Samsung LH351B (105.7lm @ 250mA) P=0.7W I=250mA

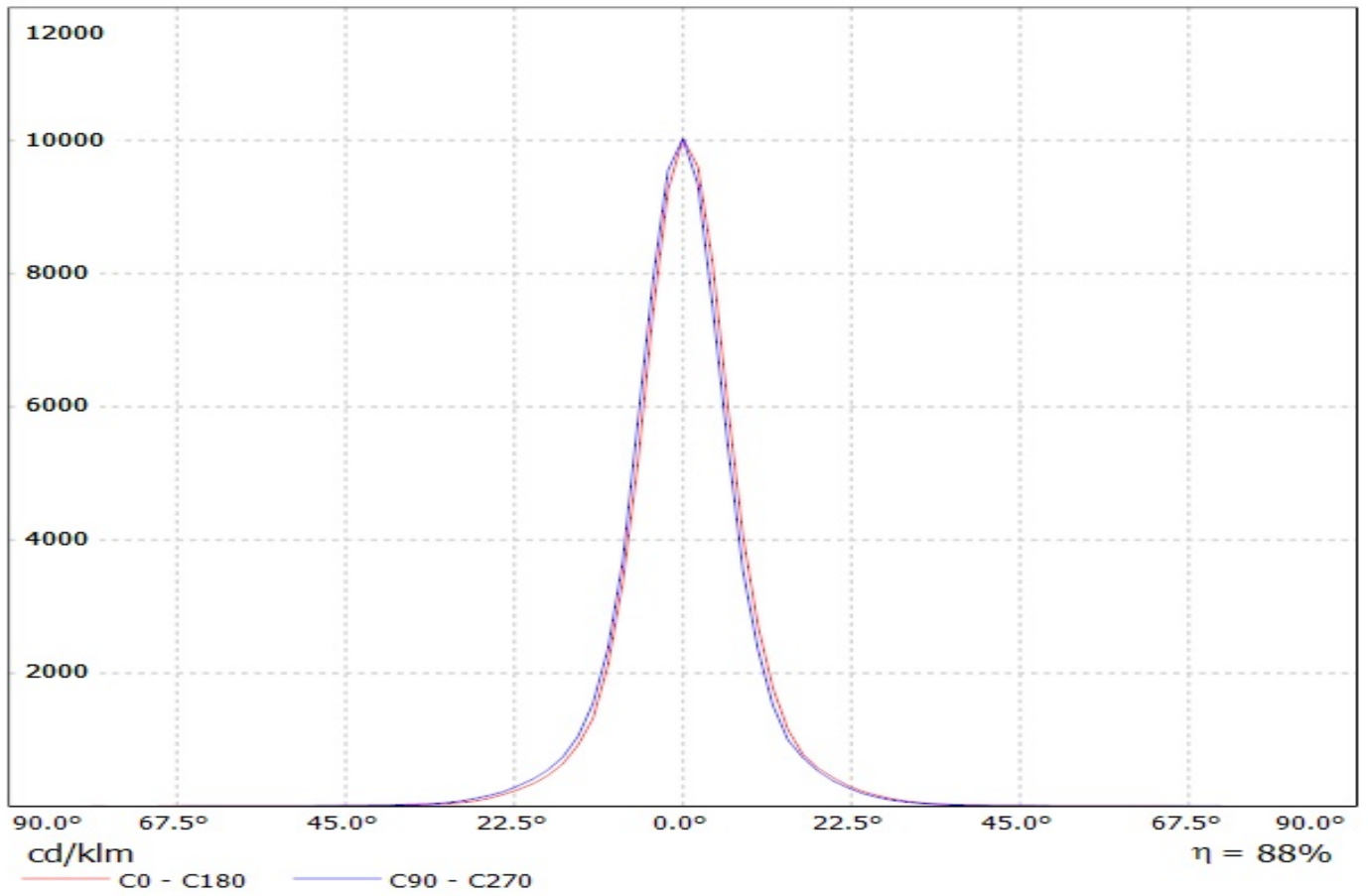

Luminaire: LEDiL Oy CA11264_HEIDI-D_(XP-G2) Efficiency=88%
Lamps: 1 x Cree XP-G2 103lm @ 250mA CCT= P=0.80W I=250mA

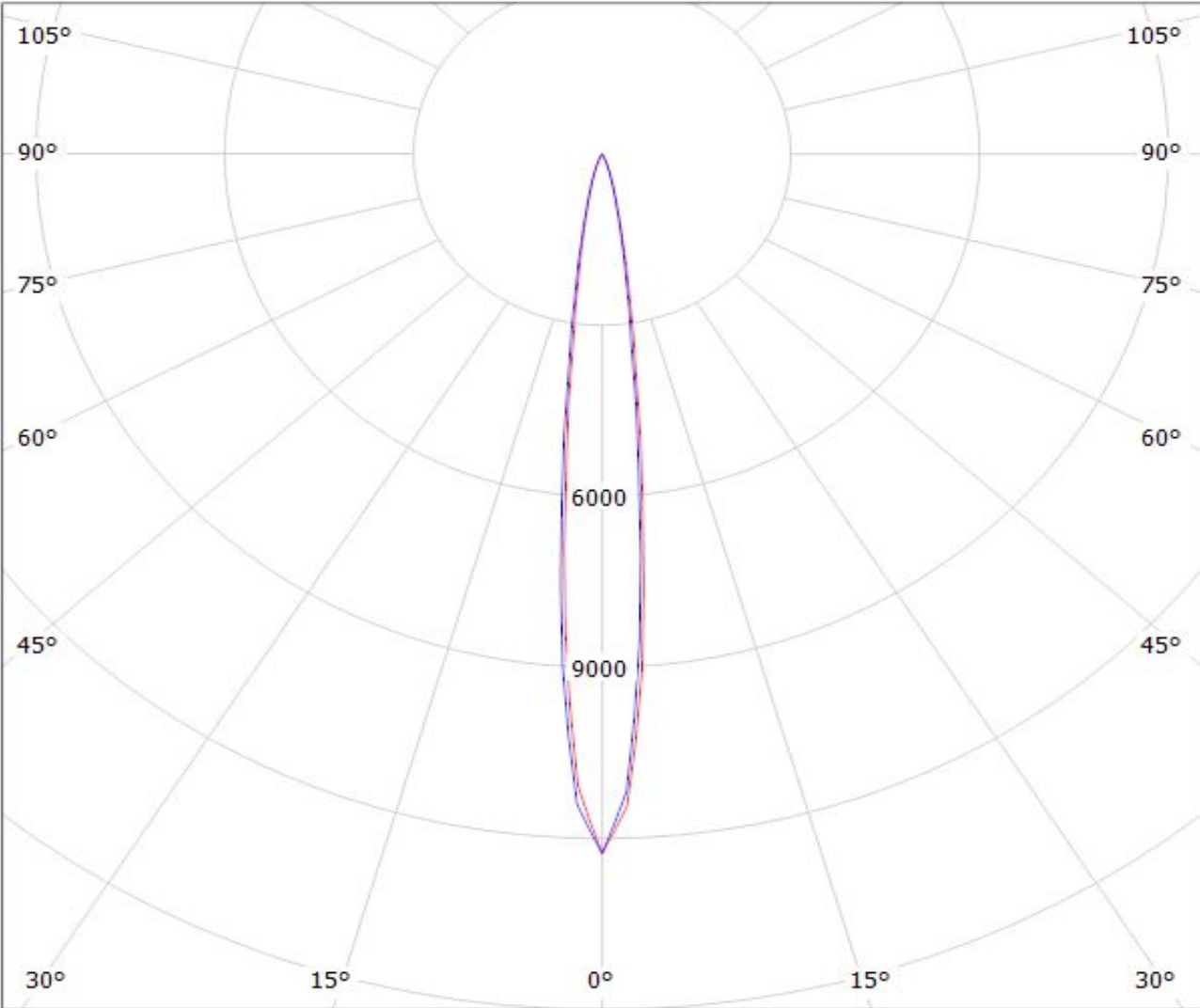

cd/klm

— C0 - C180 — C90 - C270

$\eta = 88\%$

Luminaire: LEDiL Oy CA11264_HEIDI-D Eff. 88%
Lamps: 1 x Cree XP-E2 92lm@250mA CCT=5500K P=0.8W

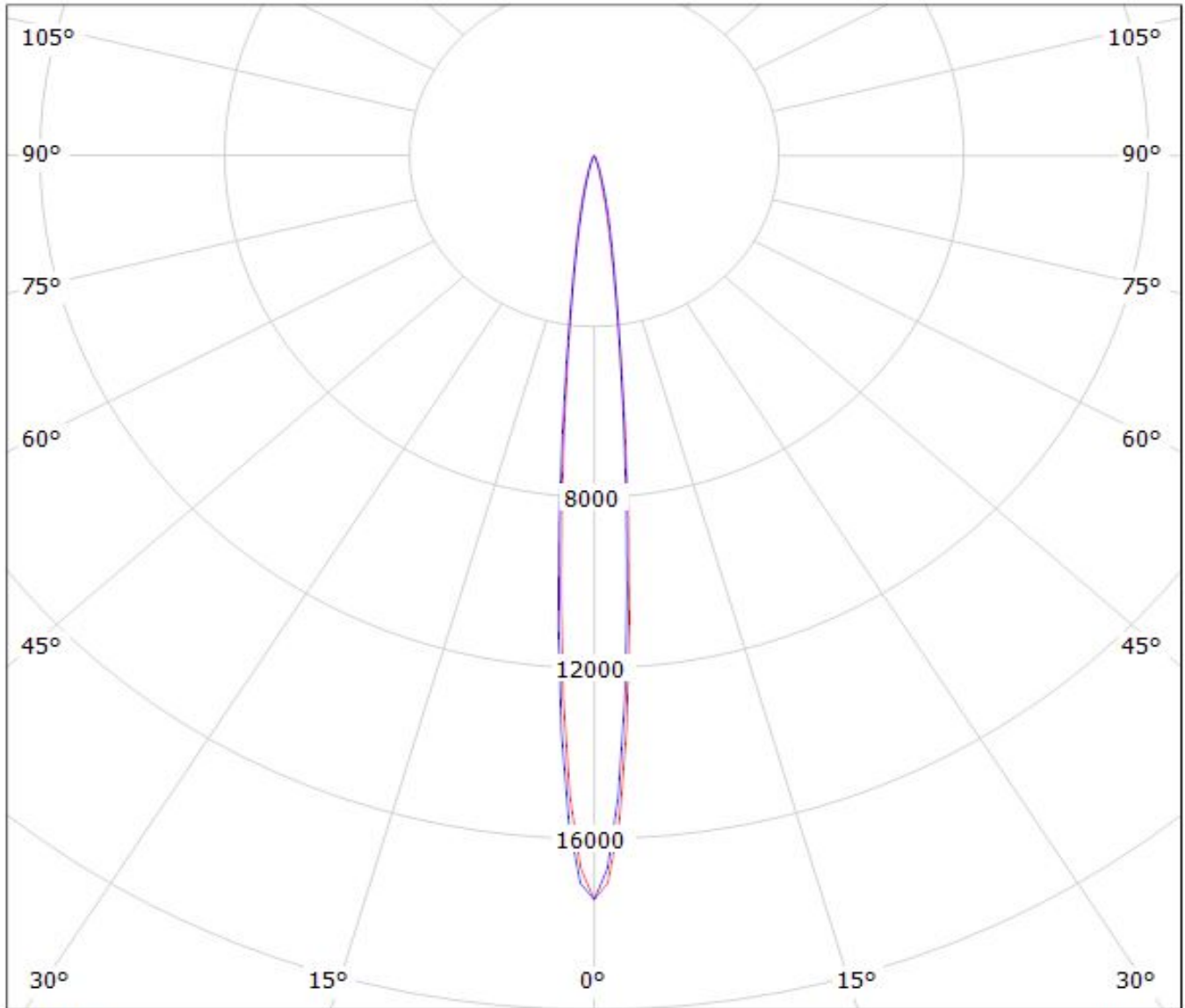

cd/klm

$\eta = 88\%$

— C0 - C180 — C90 - C270

Luminaire: LEDiL Oy CA11264_HEIDI-D_(XQ-E-HI)

Lamps: 1 x Cree_XQ-E_HI_100.602lm@250mA_P=0.744629W_I=0.25A

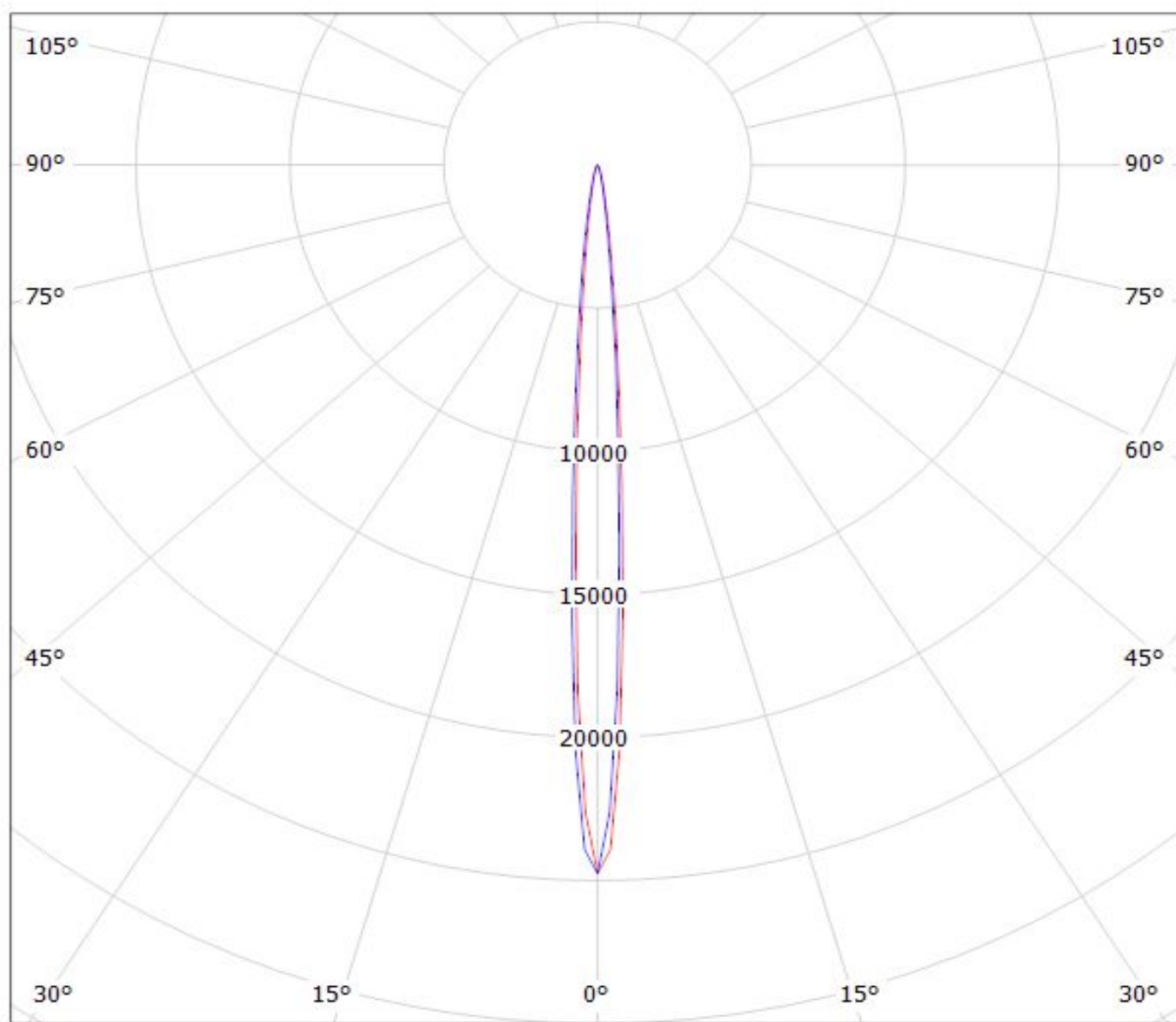

cd/klm

— C0 - C180

— C90 - C270

$\eta = 93\%$

LEDiL Oy CA11264_HEIDI-D_(LUXEON_T)_2 Eff.90.1% / LDC (Polar)

Luminaire: LEDiL Oy CA11264_HEIDI-D_(LUXEON_T)_2 Eff.90.1%

Lamps: 1 x LUXEON T (74lm@250mA)

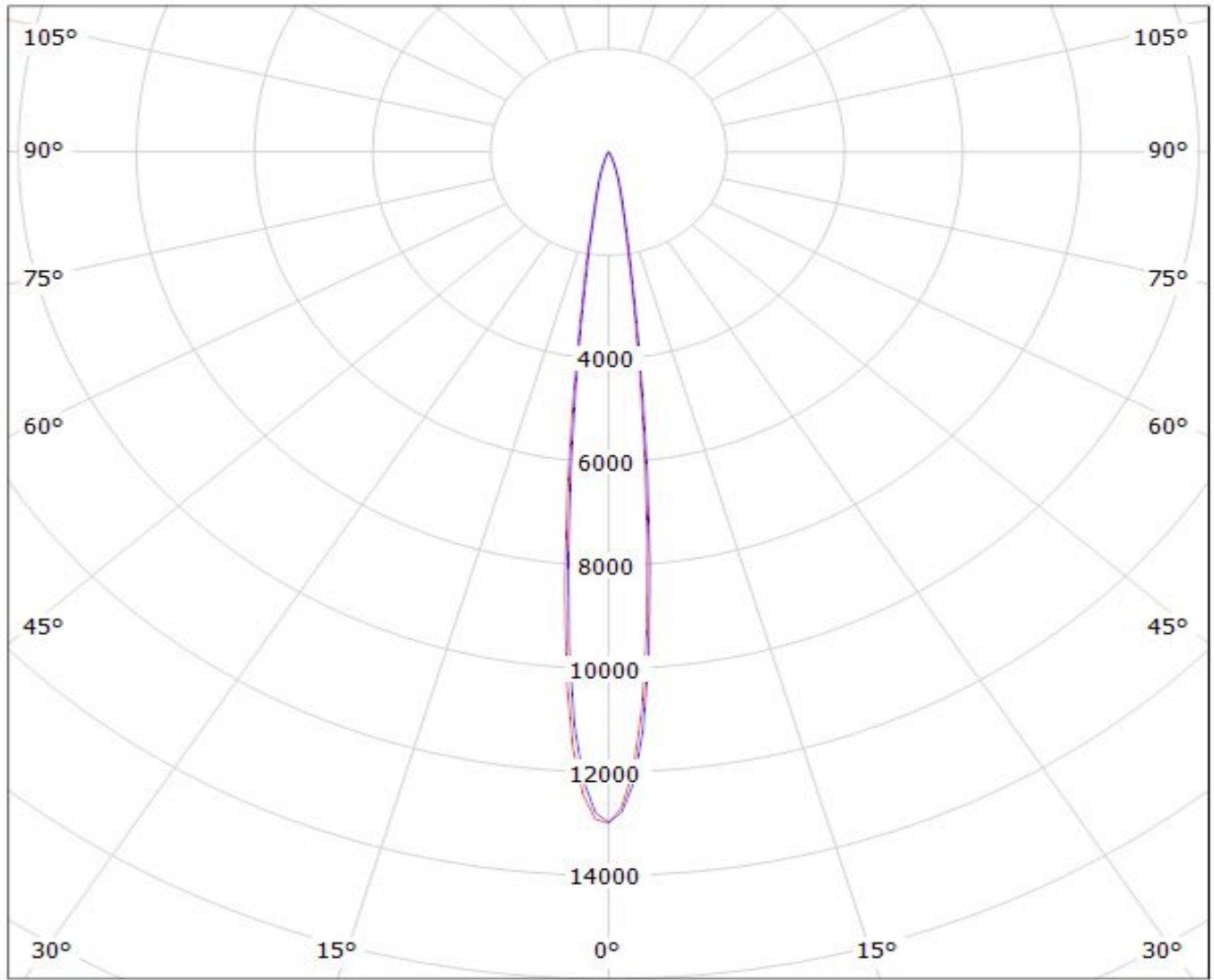

cd/klm

$\eta = 90\%$

— C0 - C180

— C90 - C270

Luminaire: Ledil Oy CA11264_HEIDI-D_(Luxeon_TX) Efficiency= 88%
Lamps: 1 x Luxeon TX (L1T2-3585) 82lm @ 250mA CCT=3521K P=0.73W I=250mA

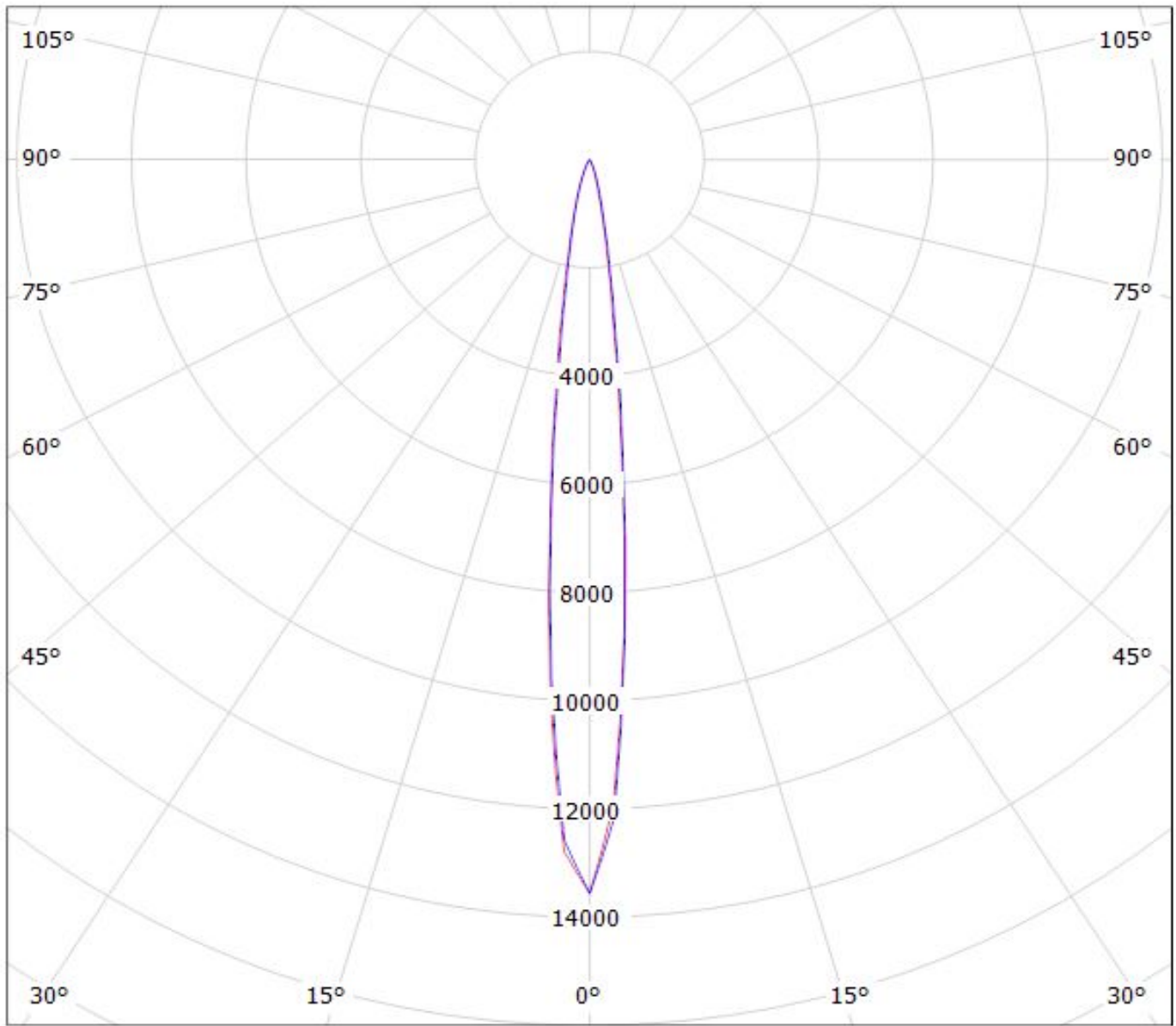

cd/klm

— C0 - C180

— C90 - C270

$\eta = 90\%$

Luminaire: Ledil Oy CA11264_HEIDI-D_(Luxeon_Z_ES)_SIMULATED
Lamps: 1 x Lumileds Luxeon Z ES

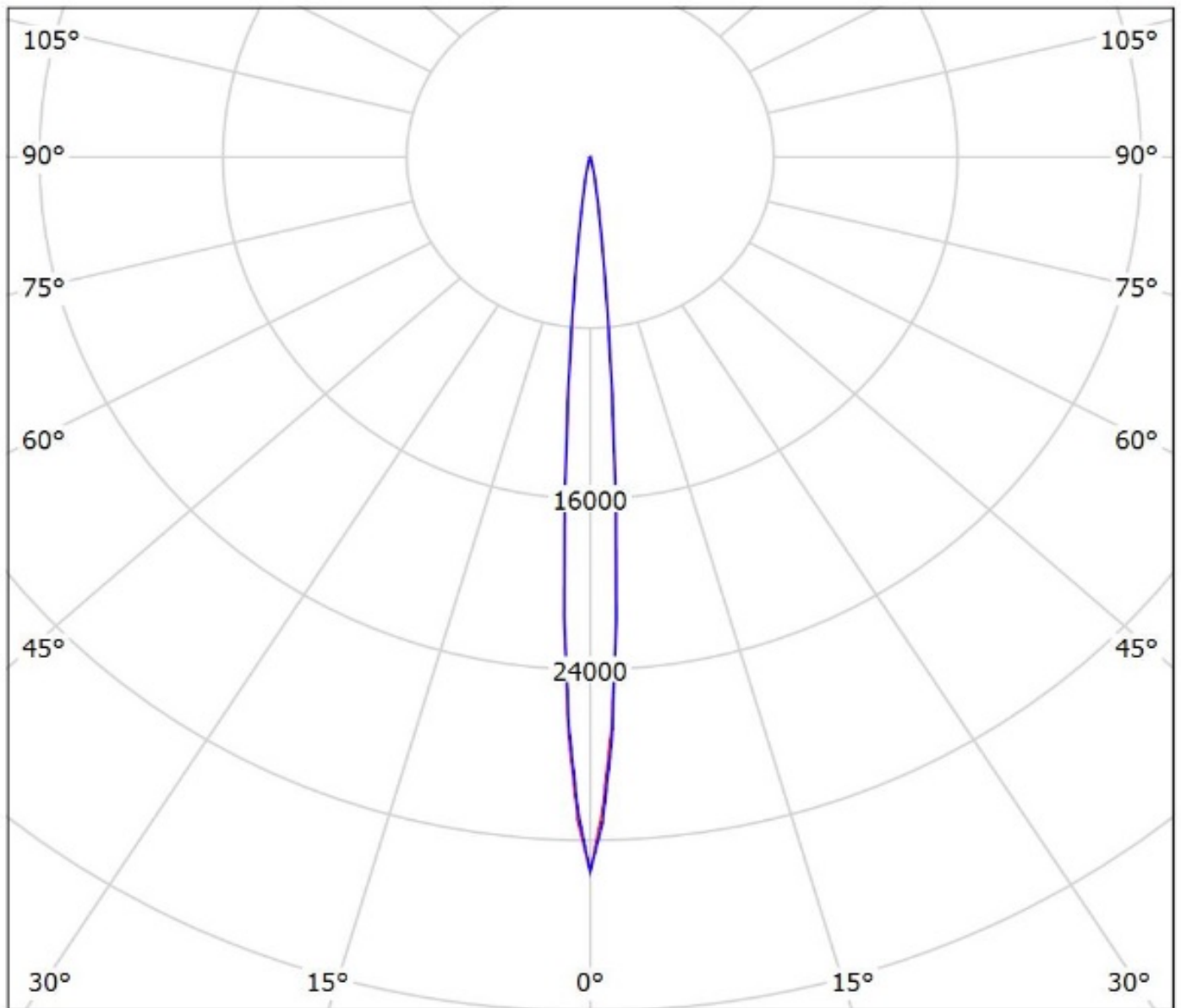

cd/klm

— C0 - C180 — C90 - C270

$\eta = 98\%$

Luminaire: LEDiL Oy CA11264_HEIDI-D_(Luxeon_C_WHITE)
Lamps: 1 x Luxeon_C_WHITE_84.6969lm@250mA_P=0.7410W_I=0.250A

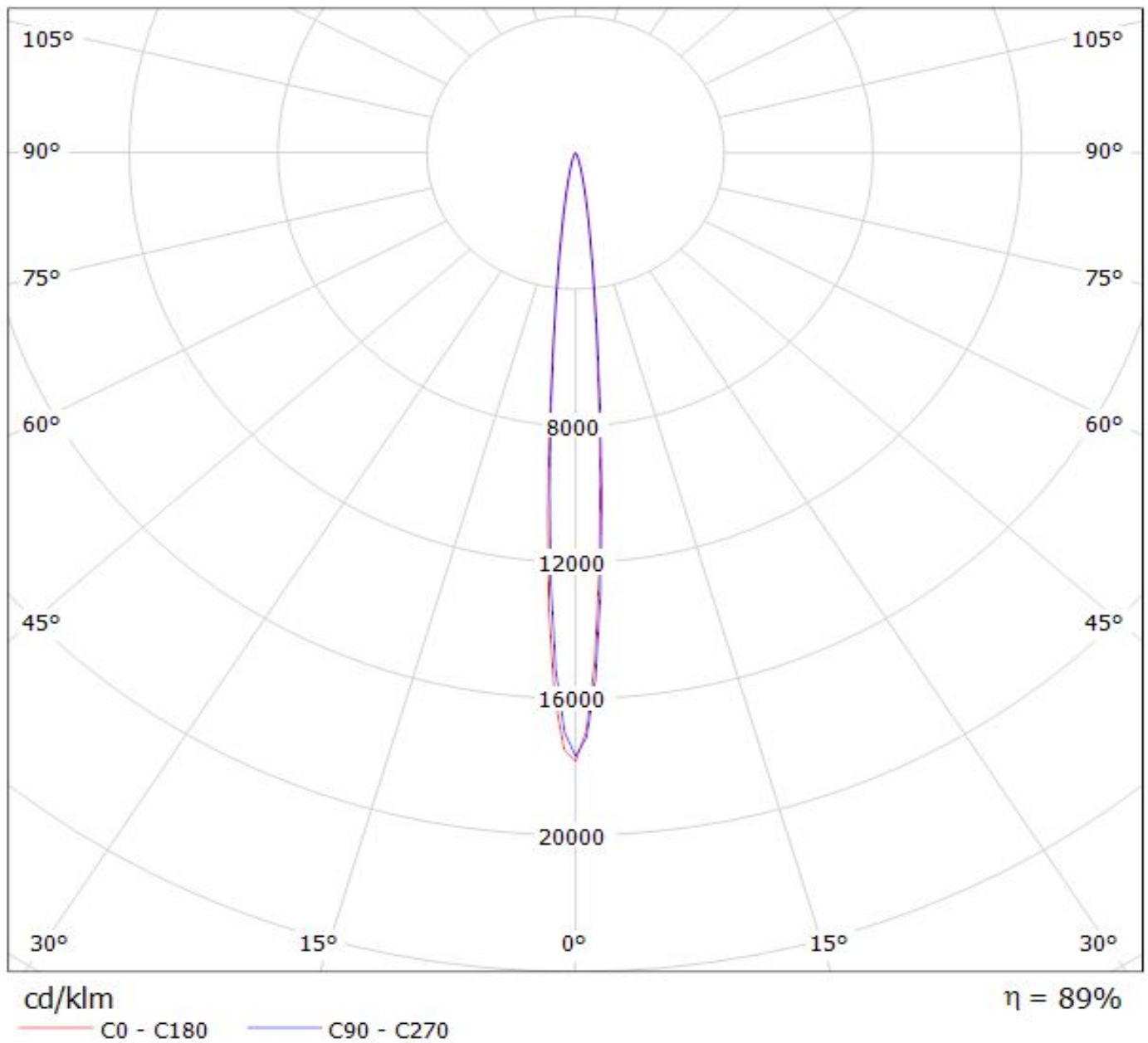

Luminaire: Ledil Oy CA11264_HEIDI-D (Nichia 219B 109lm @ 250mA) Efficiency=91%
Lamps: 1 x Nichia 219B 109lm @ 250mA

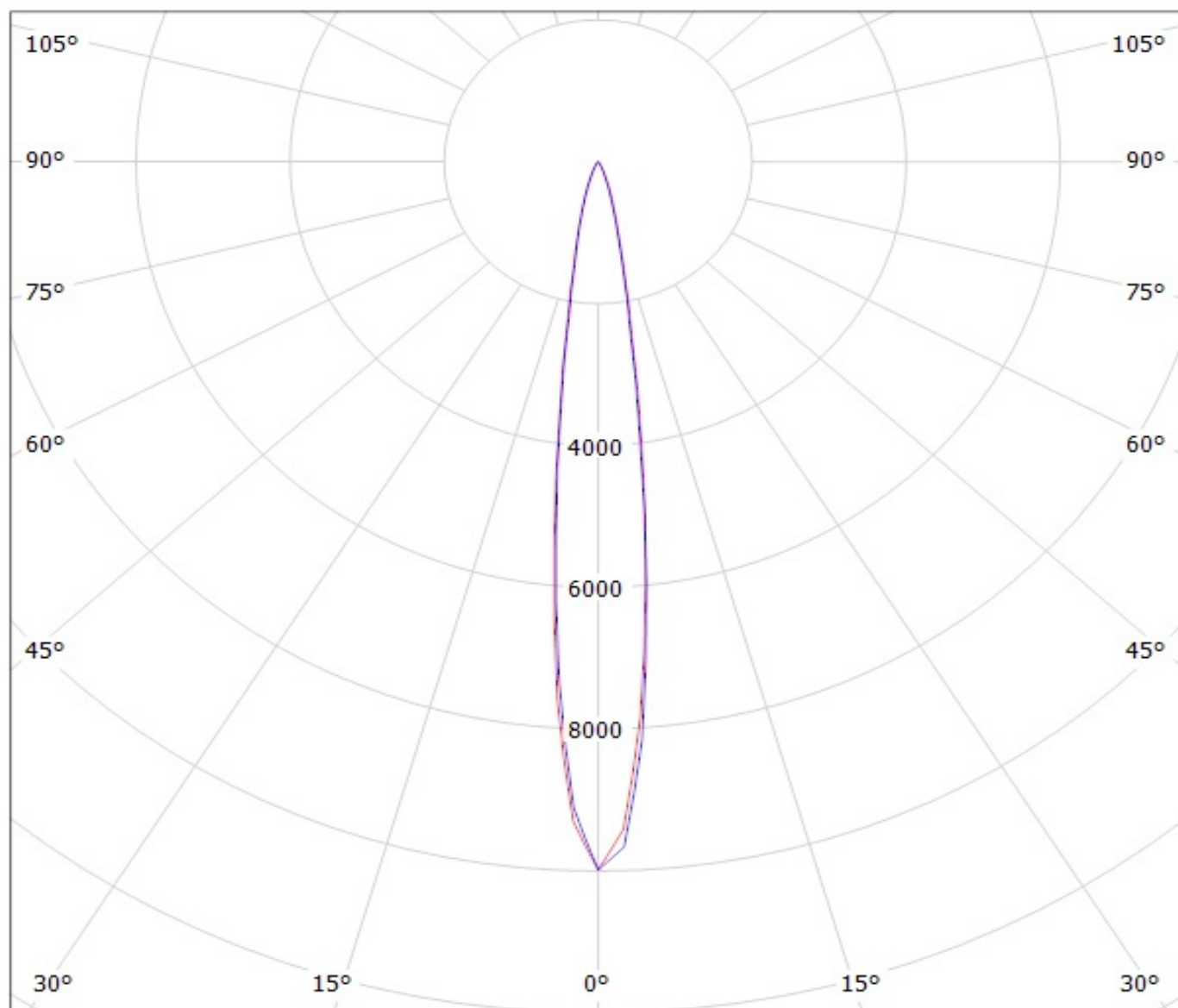

cd/klm

— C0 - C180

— C90 - C270

Luminaire: Ledil Oy CA11264_HEIDI-D_(NCSxx19B) Efficiency=85%
Lamps: 1 x Nichia NCSxx19B (NCSL119BE) 88lm @ 250mA CCT=3000K P=0.8W I=250mA

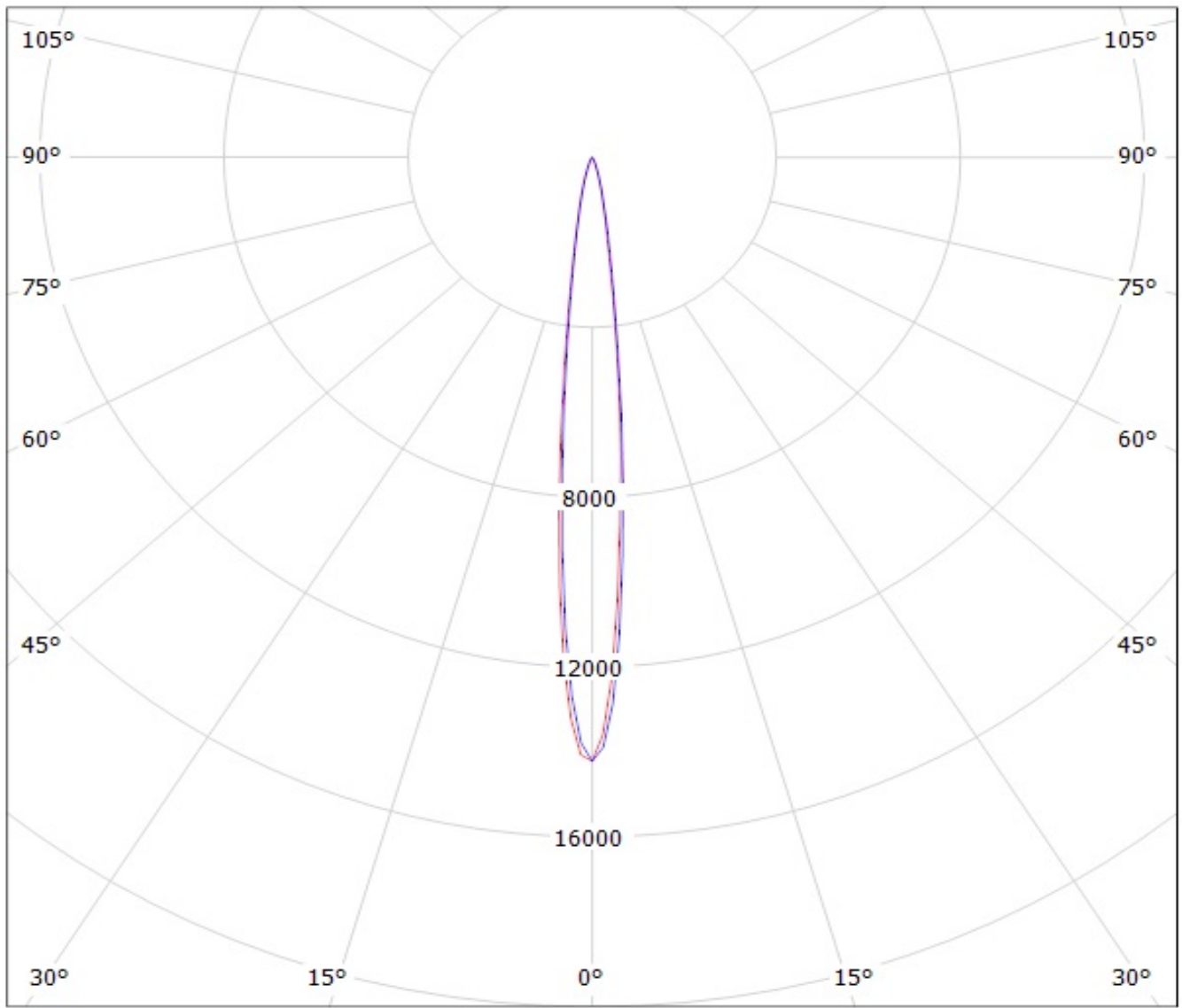

cd/klm

— C0 - C180

— C90 - C270

Luminaire: Ledil Oy CA11264_HEIDI-D_(LH351Z) Efficiency=88%
Lamps: 1 x Samsung LH351Z (90.14lm @ 250mA) CCT=6500K P=0.7W I=250mA

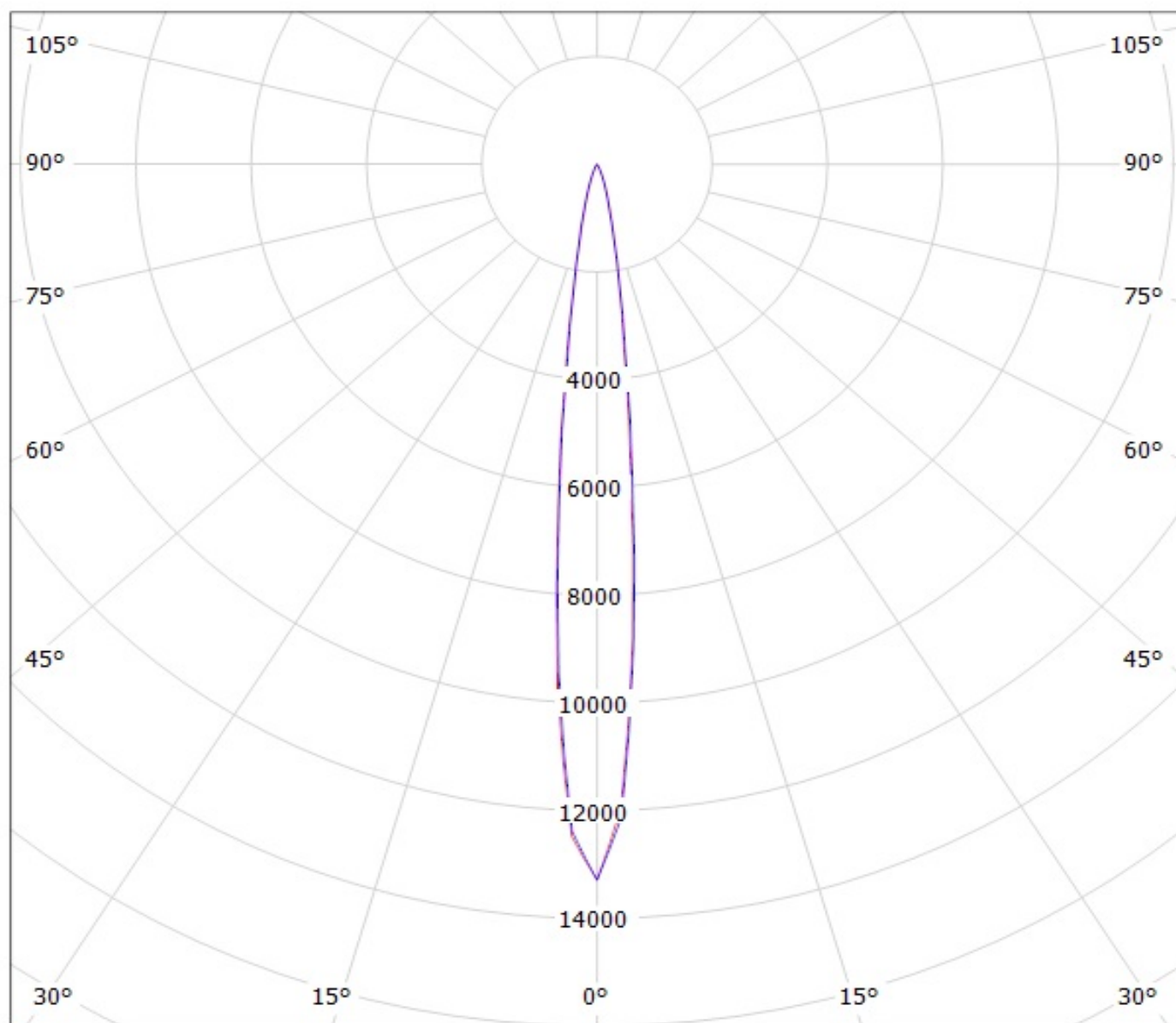

cd/klm

— C0 - C180

— C90 - C270

Luminaire: Ledil Oy CA11264_HEIDI-D_(LH351B)

Lamps: 1 x Samsung LH351B (105.7lm @ 250mA) P=0.7W I=250mA

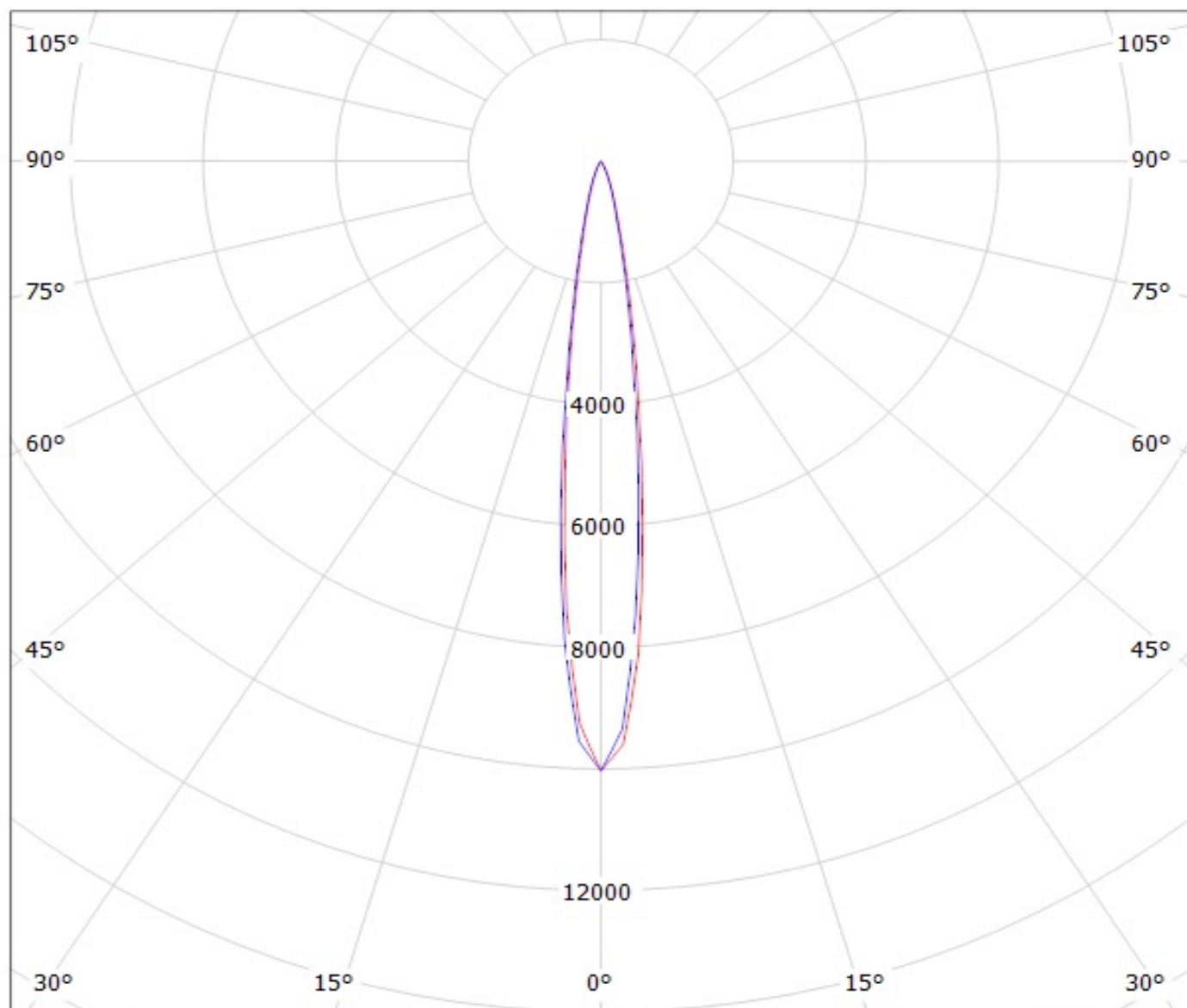

cd/klm

— C0 - C180

— C90 - C270

$\eta = 88\%$

NOTE: The typical divergence will be changed by different color, chip size and chip position tolerance. The typical total divergence is the full angle measured where the luminous intensity is half of the peak value.